



2006 Boeing Business Jet S/N 35990



# 2006 Boeing Business Jet S/N 35990

## HIGHLIGHTS

HAS BEEN PRIVATELY FLOWN AND  
MANAGED SINCE ENTERING SERVICE



FRESH BOEING DELIVERY: NOVEMBER 2006



ENTRY TO SERVICE: APRIL 2008



COMPLETION BY GORE DESIGN COMPLETION LTD.



LOW CABIN ALTITUDE (8,000 FT. TO 6,500 FT.) COMPLETED



15 PAX INTERIOR WITH 3 SEPARATED LIVING ZONES



TO BE DELIVERED WITH NEW WHITE PAINT

## AIRFRAME

TOTAL TIME SINCE NEW	1,926 Hours (as of May 28, 2017)
TOTAL LANDINGS SINCE NEW	508 Landings
ENTRY INTO SERVICE DATE	April 2008
MAINTENANCE TRACKING	Flight Docs
CERTIFICATION	Korean Registration



## ENGINES

	Left Engine	Right Engine
DESCRIPTION	CFM56-7B27/B3	
SERIAL NUMBER(S)	894300	894304
TOTAL HOURS SINCE NEW	1,926 Hours	1,926 Hours
TOTAL CYCLES SINCE NEW	508 Cycles	508 Cycles
HSI DUE/OVERHAUL DUE	On Condition	



## APU

DESCRIPTION	Honeywell GTCP 131-9B
SERIAL NUMBER	P-7309
APU TOTAL TIME SINCE NEW	3,163 Hours
HSI DUE/OVERHAUL DUE	On Condition

JETCRAFT 

INFO@JETCRAFT.COM +1 919 941 8400 JETCRAFT.COM

Specifications and/or descriptions are provided as introductory information only and do not constitute representations or warranties. Verification of specifications remain the sole responsibility of purchaser. Aircraft is subject to prior sale, lease, and/or removal from the market without prior notice.

# 2006 Boeing Business Jet S/N 35990

## AVIONICS

DUAL SMITH FMS  
TWO (2) UNIVERSAL NAVIGATION SYSTEMS UCD SYSTEMS  
DUAL HONEYWELL HG205OACO7 ADIRU  
THREE VHF COMM  
8.33 SPACING ON COMM  
DUAL ROCKWELL COLLINS HF COMM  
ROCKWELL COLLINS TTR920 TCAS  
DUAL HONEYWELL GPS  
DUAL ROCKWELL COLLINS TPR 901 TRANSPONDERS

HONEYWELL EGPWS MARK VII  
ROCKWELL COLLINS DME 9000  
MAGNASTAR C-2000 PHONE SYSTEM  
HONEYWELL MCS 6000 SATCOM  
SELCAL  
HUD (HEADS UP DISPLAY)  
AFIS  
FA2100 COCKPIT VOICE RECORDER  
FA2100 FLIGHT DATA RECORDER  
FANS-1 EQUIPPED

## FEATURES/OPTIONS

3RD FMS  
CABIN HUMIDIFIERS  
SKYSHOW SYSTEM (CUSTOM CONTROL CONCEPTS INC)  
406 MHZ ELT  
10.4" PERSONAL MONITORS FOR ALL SEATS  
ENHANCED SURVEILLANCE WITH FLIGHT ID  
AIRCELL GOGO SYSTEM + SWIFT BROADBAND  
FAX / COPIER / SCANNER MACHINE  
XM RADIO  
SEVEN (7) PATS LONG RANGE AUXILIARY FUEL TANKS  
- TWO (2) FORWARD & FIVE (5) AFT  
BROADCAST TV  
DOWN & TAIL CAMERA  
INSTALLED NAV DATA LOADER  
K PLAYER  
ICE DETECTOR SYSTEM  
CCC CABIN MANAGEMENT SYSTEM  
CCC IN-FLIGHT ENTERTAINMENT SYSTEM WITH AVOD

## MAJOR INSPECTION STATUS

Inspection	Last performed	Next due
1C (48 MONTH)	August 2016	August 2020
2C (96 MONTH)	June 2014	June 2022
3C (144 MONTH)	April 2008	April 2020

# 2006 Boeing Business Jet S/N 35990

## INTERIOR

	Description
<b>NUMBER OF PASSENGERS</b>	15 Passengers
<b>GALLEY LOCATION</b>	Forward Right Hand Side Crew Galley with Storage, Mid Cabin Forward and Aft Facing Galleys
<b>MAIN LOUNGE CONFIGURATION</b>	Twelve (12) 16g Executive swivel Single Seats, One (1) 46" LCD Monitor, Guest Lavatory (Toto Bidet)
<b>VIP LOUNGE CONFIGURATION</b>	Four (4) Executive 16g Executive swivel Single Seats, One (1) 46" LCD Monitor, One (1) Humidifier
<b>MASTER BEDROOM CONFIGURATION</b>	Two (2) 16g Executive Swivel Single Seats, 48"x76" Bed, 46" LCD Monitor, VIP Lavatory, 20" LCD Monitor (Toto Bidet)
<b>LAVATORY LOCATION(S)</b>	Forward Crew Area, Main Lounge, Aft VIP Lavatory off the Master Bedroom
<b>CREW REST</b>	Located in the Forward Cabin, Complete with right Hand Side Storage Complex and Galley; Full Recline Crew Rest, Crew Lavatory
<b>GALLEY COMPLEX</b>	Single Kibitzer Style Crew Rest Seat, Full Complement of Galley Equipment

## EXTERIOR

<b>BASE PAINT COLOR(S)</b>	Overall White
<b>LAST PAINTED DATE</b>	To be Delivered New

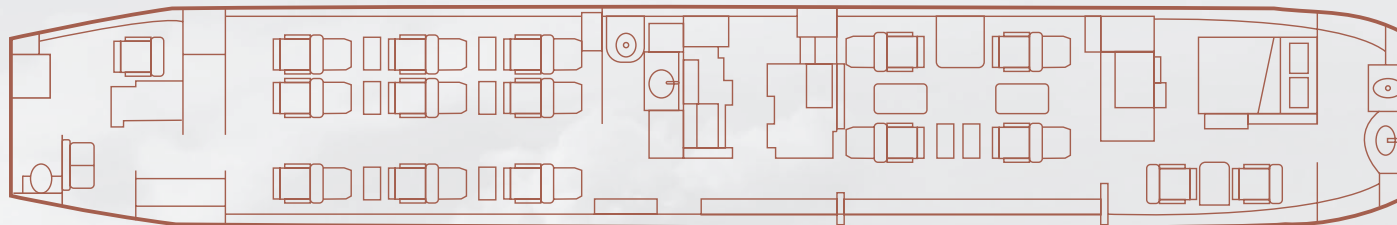



# 2006 Boeing Business Jet s/N 35990



# 2006 Boeing Business Jet S/N 35990





# 2006 Boeing Business Jet s/N 35990





# 2006 Boeing Business Jet s/N 35990





# 2006 Boeing Business Jet s/N 35990





# 2006 Boeing Business Jet s/N 35990



